

Licensing Sub-Committee Report

Item No:	
Date:	3 March 2022
Licensing Ref No:	21/09030/LIPN - New Premises Licence
Title of Report:	Shadow Licence Ground Floor 6 Bedford Street London WC2E 9HZ
Report of:	Director of Public Protection and Licensing
Wards involved:	St James's
Policy context:	City of Westminster Statement of Licensing Policy
Financial summary:	None
Report Author:	Jessica Donovan Senior Licensing Officer
Contact details	Telephone: 020 7641 6500 Email: Jdonovan@westminster.gov.uk

1. Application

1-A Applicant and premises			
Application Type:	New Premises Licence, Licensing Act 2003		
Application received date:	6 September 2021		
Applicant:	Legal And General Assurance (Pensions Management) Limited		
Premises:	Shadow Licence		
Premises address:	Ground Floor 6 Bedford Street London WC2E 9HZ	Ward:	St James's
		Cumulative Impact Area:	West End
		Special Consideration Zone:	None
Premises description:	The premises currently operate as a restaurant. This application seeks a premises licence on the same terms, plans and conditions as 21/00270/LIPCH.		
Premises licence history:	The premises has had the benefit of a premises licence since 2005. The current premises licence (21/00270/LIPCH) can be viewed at Appendix 3 of this report along with the premises history.		
Applicant submissions:	Following consultation, the applicant provided a mediation email for the interested party which can be found at Appendix 2 .		
Applicant amendments:	None		

1-B Proposed licensable activities and hours							
Recorded Music:				Indoors, outdoors or both			Indoors
Day:	Mon	Tues	Wed	Thur	Fri	Sat	Sun
Start:	00:00	00:00	00:00	00:00	00:00	00:00	00:00
End:	00:00	00:00	00:00	00:00	00:00	00:00	00:00
Seasonal variations/ Non-standard timings:			N/A				

Private Entertainment consisting of dancing, music or other entertainment of a like kind for consideration and with a view to profit :				Indoors, outdoors or both			Indoors
Day:	Mon	Tues	Wed	Thur	Fri	Sat	Sun
Start:	00:00	00:00	00:00	00:00	00:00	00:00	00:00
End:	00:00	00:00	00:00	00:00	00:00	00:00	00:00
Seasonal variations/ Non-standard timings:			N/A				

Late Night Refreshment:				Indoors, outdoors or both			Indoors
Day:	Mon	Tues	Wed	Thur	Fri	Sat	Sun
Start:	23:00	23:00	23:00	23:00	23:00	23:00	23:00
End:	00:30	00:30	00:30	00:30	01:30	01:30	00:00
Seasonal variations/ Non-standard timings:		For times authorised for Christmas, New Year and Good Friday see the conditions at Annex 1 of the licence which can be found at Appendix 3 .					

Sale by retail of alcohol				On or off sales or both:			Both
Day:	Mon	Tues	Wed	Thur	Fri	Sat	Sun
Start:	10:00	10:00	10:00	10:00	10:00	10:00	12:00
End:	00:00	00:00	00:00	00:00	01:00	01:00	23:30
Seasonal variations/ Non-standard timings:		For times authorised for Christmas, New Year and Good Friday see the conditions at Annex 1 of the licence which can be found at Appendix 3 .					

Hours premises are open to the public							
Day:	Mon	Tues	Wed	Thur	Fri	Sat	Sun
Start:	10:00	10:00	10:00	10:00	10:00	10:00	12:00
End:	00:30	00:30	00:30	00:30	01:30	01:30	00:00
Seasonal variations/ Non-standard timings:		N/A					

2. Representations

2-A Responsible Authorities	
Responsible Authority:	The Licensing Authority
Representative:	Kevin Jackaman
Received:	30 September 2021

I write in relation to the application submitted for a new premises licence for Ground Floor, 6 Bedford Street, London, WC2E 9HZ

As a responsible authority under section 13 (4) of the Licensing Act 2003 as amended under the Police and Social Responsibility Act 2011 the Licensing Authority have considered your application in full. The Licensing Authority has concerns in relation to this application and how the premises would promote the Licensing Objectives:

- Prevention of Public Nuisance
- Prevention of Crime & Disorder
- Public Safety
- Protection of children from harm

The application is for a 'shadow' licence of premises licence 21/00270/LIPCH. Please can you confirm the interest of the Legal And General Assurance (Pensions Management) Limited in the property?

The Licensing Authority has reviewed the application against the current premises Licence and it has been made on the same terms and with the same conditions as the existing licence.

In the Council's statement of Licencing Policy, point D.20 and F.39 state:

"The Licensing Authority may consider granting applications for licences within the West End Cumulative Impact Zone that duplicate the terms and conditions of the current operational licence for that same premises but are issued to the landowner, or other person with an interest in the property and that the licence has no affect by condition. These 'Shadow Licences' are normally sought by the landowner to protect the interest of their property due to the policy to refuse certain new applications. A Shadow Licence will, in the event that a licence lapses, is surrendered or is revoked the property own can look to market the property with the licence. The holder of the Shadow Licence would in those circumstances need to apply to the Licensing Authority to vary the licence to remove any conditions preventing the use of that licence. At that point the Licensing Authority will consider whether the operation of the premises is likely to be an exception to policy. It will be for the Shadow Licence licensee to demonstrate that they are an exception within the applications operating schedule."

With this in mind the Licensing Authority would like the applicant to accept the Council's amended model condition 97 which states:

"The shadow licence will not take effect when the current licence is in operation."

Subject to the above the Licensing Authority will be minded to withdraw its objection.

Please accept this as a formal representation and I look forward to hearing from you.

2-B Other Persons			
Name:		[REDACTED]	
Address and/or Residents Association:		[REDACTED] [REDACTED] [REDACTED]	
Status:	Valid	In support or opposed:	Opposed
Received:	17 September 2021		

As the application is incomplete, see below, we must assume it is non-compliant, as a license cannot be issued either in perpetuity, or to a non-disclosed individual responsible for the implementation of the license on the nominated premises:

- no supervisor nominated
- conditions referenced have not been attached for:
 - general licensing
 - prevention of crime & disorder
 - public safety
 - protection of children from harm

Application is uncompliant:

- states the premises will only be open no later than 0130 on any given day, however will play recorded music on all days from 0000-2400 (ie all the time) - see Part F of the application. As there is no detail on the noise pollution levels of the recorded music we must assume this is non-compliant until further detail is provided.

[REDACTED] I am not against encourage good business in the local area, however as we have ongoing crime, disturbance, traffic, public safety & hygiene issues on the intersection of Bedford & Chandos St, we must ensure compliance with a full submission that allows the council to work with the business to mitigate risks.

3. Policy & Guidance

The following policies within the City Of Westminster Statement of Licensing Policy apply:	
Policy CIP1 applies	<p>A. It is the Licensing Authority's policy to refuse applications within the West End Cumulative Impact Zone for: pubs and bars, fast food premises, and music and dancing and similar entertainment, other than applications to:</p> <ol style="list-style-type: none"> 1. Vary the hours within Core Hours under Policy HRS1, and/or 2. Vary the licence to reduce the overall capacity of the premises. <p>C. Applications for other premises types within the West End Cumulative Impact Zones will be subject to other policies within this statement and must demonstrate that they will not add to cumulative impact.</p> <p>D. For the purposes of this policy the premises types referred to in Clause A are defined within the relevant premises use policies within this statement.</p>
Policy HRS1 applies	<p>A. Applications within the core hours set out below in this policy will generally be granted for the relevant premises uses, subject to not being contrary to other policies in the Statement of Licensing Policy.</p> <p>B. Applications for hours outside the core hours set out in Clause C will be considered on their merits, subject to other relevant policies, and with particular regard to the following:</p> <ol style="list-style-type: none"> 1. The demonstration of compliance in the requirements of policies CD1, PS1, PN1 and CH1 associated with the likelihood of the effect of the grant of a licence for later or earlier hours on crime and disorder, public safety, public nuisance and the protection of children from harm. 2. If the application is located within a Special Consideration Zone they have demonstrated that they have taken account of the issues identified in that area and provided adequate mitigation. 3. Whether there is residential accommodation in the proximity of the premises that would likely be adversely affected by premises being open or carrying out operations at the hours proposed. 4. The proposed hours of the licensable activities and when customers will be permitted to remain on the premises. 5. The proposed hours when any music, including incidental music, will be played. 6. The hours when customers will be allowed to take food or drink outside the premises or be within open areas which form part of the premises. 7. The existing hours of licensable activities and the past operation of the premises (if any) and hours of licensable premises in the vicinity. 8. Whether customers and staff have adequate access to public transport when arriving at and leaving the premises, especially at night. 9. The capacity of the premises. 10. The type of use, recognising that some venues are more likely to impact the licensing objectives than others; for example, pubs and bars are higher risk than theatres, cinemas and other cultural and sporting venues due to the nature of the operation. 11. The Licensing Authority will take into account the active measures proposed for a 'winding down' period including arrangements for people to be collected from the premises to travel

home safely.

12. Conditions on hours may be attached that require that the supply of alcohol for consumption on the premises ceases a suitable period of time before customers are required to leave the premises.

13. The council, acting as the Licensing Authority, may reduce hours if, after review, it is necessary to impose conditions specifying shorter hours in order to promote the licensing objectives.

14. Specific days for non-standard hours should be identified and justified as part of the application to allow responsible authorities and interested parties to evaluate the impact that these licensable activities may have, and to plan accordingly. The consideration of applications for later hours for Bank Holiday Mondays will take into account that later hours are generally granted for preceding Sundays and that the next day is a working day. Non-specific days are expected to be covered by Temporary Event Notices or variation applications.

C. For the purpose of Clauses A and B above, the Core Hours for applications for each premises use type as defined within this policy are:

1. **Casinos:** Up to 24 hours a day whilst casino gaming is permitted by a premises licence under the Gambling Act 2005.

2. **Cinemas, Cultural Venues and Live Sporting Premises:**

Monday to Sunday: 9am to 12am

3. **Hotels:** Monday to Thursday: 9am to 11.30pm. Friday and Saturday: 9am to 12am. Sunday: 9am to 10.30pm. Sundays immediately prior to a bank holiday: 9am to 12am. For the sale of alcohol to guests for consumption in hotel/guest rooms only: Anytime up to 24 hours.

4. **Off licences:** Monday to Saturday: 8am to 11pm. Sunday: 9am to 10.30pm.

5. **Outdoor Spaces:** Monday to Thursday: 9am to 11.30pm. Friday and Saturday: 9am to 12am. Sunday: 9am to 10.30pm. Sundays immediately prior to a bank holiday: 9am to 12am.

6. **Pubs and bars, Fast Food and Music and Dance venues:**

Monday to Thursday: 10am to 11.30pm. Friday and Saturday: 10am to 12am. Sunday: 9am to 10.30pm. Sundays immediately prior to a bank holiday: 12pm to 12am.

7. **Qualifying Clubs:** Monday to Thursday: 9am to 12am.. Friday and Saturday: 9am to 12am. Sunday: 9am to 10.30pm. Sundays immediately prior to a bank holiday: 9am to 12am.

8. **Restaurants:** Monday to Thursday: 9am to 11.30pm. Friday and Saturday: 9am to 12am. Sunday: 9am to 10.30pm. Sundays immediately prior to a bank holiday: 9am to 12am.

9. **Sexual Entertainment Venues and Sex Cinemas:** Monday to Thursday: 9am to 11.30pm. Friday and Saturday: 9am to 12am. Sunday: 9am to 10.30pm. Sundays immediately prior to a bank holiday: 9am to 12am.

D. Core hours are when customers are permitted to be on the premises and therefore the maximum opening hours permitted will be to the same start and terminal hours for each of the days where licensable activity is permitted.

E. For the purposes of this policy, 'premises uses' are defined within the relevant premises use policies within this statement.

<p>Policy RNT1 (B) applies</p>	<p>B. Applications inside the West End Cumulative Impact Zone will generally be granted subject to:</p> <ol style="list-style-type: none"> 1. The application meeting the requirements of policies CD1, PS1, PN1 and CH1. 2. The hours for licensable activities are within the council's Core Hours Policy HRS1. 3. The operation of any delivery services for alcohol and/or latenight refreshment meeting the council's Ancillary Delivery of Alcohol and/or Late-Night Refreshment Policy DEL1. 4. The applicant has demonstrated that they will not add to cumulative impact within the Cumulative Impact Zone. 5. The application and operation of the venue meeting the definition of a restaurant as per Clause C. <p>C. For the purposes of this policy a restaurant is defined as:</p> <ol style="list-style-type: none"> 1. A premises in which customers are shown to their table or the customer will select a table themselves to which food is either served to them or they have collected themselves. 2. Which provide food in the form of substantial table meals that are prepared on the premises and are served and consumed at a table. 3. Which do not provide any takeaway service of food and/or drink for immediate consumption, except if provided via an ancillary delivery service to customers at their residential or workplace address. 4. Where alcohol shall not be sold, supplied, or consumed on the premises otherwise than to persons who are bona fide taking substantial table meals and provided always that the consumption of alcohol by such persons is ancillary to taking such meals. 5. The sale and consumption of alcohol prior to such meals may be in a bar area but must also be ancillary to the taking of such meal.
---------------------------------------	--

4. Equality Implications

The Council in its capacity as Licensing Authority has a duty to have regard to its public sector equality duty under section 149 of the Equality Act 2010. In summary, section 149 provides that a Public Authority must, in the exercise of its functions, have due regard to the need to:

- (a) eliminate discrimination harassment, victimisation and any other conduct that is prohibited by or under this Act;
- (b) advance equality of opportunity between persons who share a relevant protected characteristic and persons who do not share it; and
- (c) foster good relations between persons who share a relevant protected characteristics and persons who do not share it.

Section 149 (7) of the Equality Act 2010 defines the relevant protected characteristics as age, disability, gender reassignment, marriage and civil partnership, pregnancy and maternity, race, religion or belief, sex, and sexual orientation.

5. Appendices

Appendix 1	Premises plans
Appendix 2	Applicant supporting documents
Appendix 3	Existing premises licence and premises history
Appendix 4	Proposed conditions
Appendix 5	Residential map and list of premises in the vicinity

Report author:	Jessica Donovan Senior Licensing Officer
Contact:	Telephone: 020 7641 6500 Email: jdonovan@westminster.gov.uk

If you have any queries about this report or wish to inspect one of the background papers please contact the report author.

Background Documents – Local Government (Access to Information) Act 1972

1	Licensing Act 2003	N/A
2	City of Westminster Statement of Licensing Policy	01 October 2021
3	Amended Guidance issued under section 182 of the Licensing Act 2003	April 2018
4	The Licensing Authority	30 September 2021
5	Interested party	17 September 2021

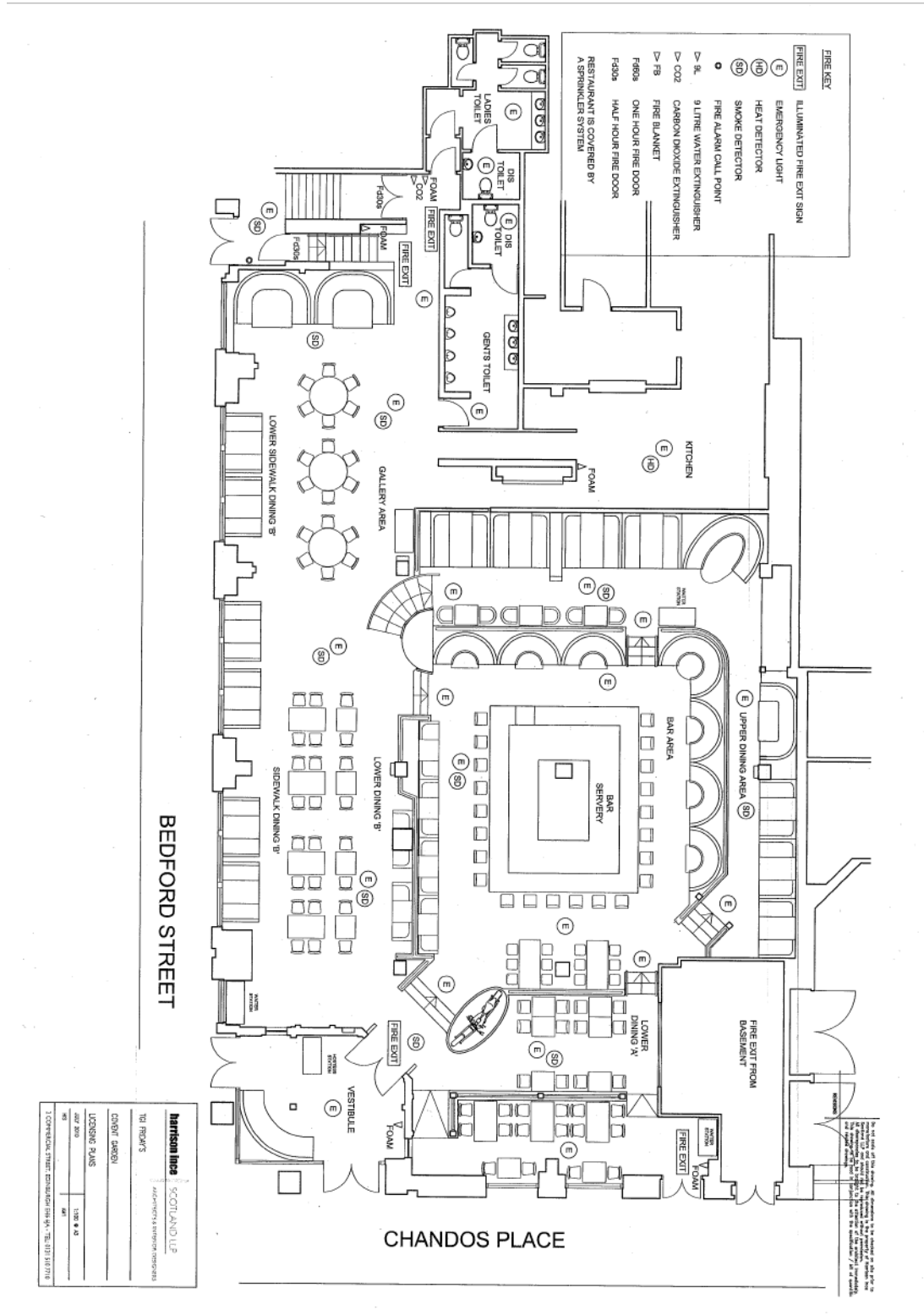

Mediation email to interested party

From: Alun Thomas

Subject: 6 Bedford Street, London, WC2E 9HZ - 21/09030

Date: 10 February 2022 15:36:23

Attachments: image001.png

Dear [REDACTED]

I act for the applicant in the above matter and the City Council has, belatedly, passed me a copy of your representation dated 17 September.

May I explain: my client is the landlord and is simply seeking a “shadow” licence on the exact same terms as the existing premises licence. Landlords often do this to have a safeguard particularly in these uncertain and difficult times.

The application seeks no changes above and above than the existing licence. I hope that satisfies your concerns. If it does, please could you let the licensing authority know.

Please let me know should you have any queries arising in the meantime.

Yours sincerely

Alun Thomas

Thomas & Thomas Partners LLP
38a Monmouth Street
London WC2H 9EP
D: 020 7042 0412
M: 07956 805464
W: www.tandtp.com



**City of Westminster
64 Victoria Street, London,
SW1E 6QP**

**Schedule 12
Part A**

**WARD: St James's
UPRN: 010033529951**

Premises licence

Regulation 33, 34

**Premises licence
number:**

21/00270/LIPCH

Original Reference:

05/06114/LIPC

Part 1 – Premises details

Postal address of premises:

TGI Fridays
Ground Floor
6 Bedford Street
London
WC2E 9HZ

Telephone Number: 020 7379 0585

Where the licence is time limited, the dates:

Not applicable

Licensable activities authorised by the licence:

Playing of Recorded Music
Late Night Refreshment
Private Entertainment consisting of dancing, music or other entertainment of a like kind for consideration and with a view to profit
Sale by Retail of Alcohol

The times the licence authorises the carrying out of licensable activities:

Playing of Recorded Music	Unrestricted
Late Night Refreshment	
Monday to Thursday:	23:00 to 00:30
Friday to Saturday:	23:00 to 01:30
Sunday:	23:00 to 00:00

Private Entertainment consisting of dancing, music or other entertainment of a like kind for consideration and with a view to profit Unrestricted

Sale by Retail of Alcohol

Monday to Thursday:	10:00 to 00:00
Friday to Saturday:	10:00 to 01:00
Sunday:	12:00 to 23:30

For times authorised for Christmas, New Year and Good Friday see conditions at Annex 1

The opening hours of the premises:

Monday to Thursday:	10:00 to 00:30
Friday to Saturday:	10:00 to 01:30
Sunday:	12:00 to 00:00

Where the licence authorises supplies of alcohol, whether these are on and/or off supplies:

Alcohol is supplied for consumption both on and off the Premises.

Part 2

Name, (registered) address, telephone number and email (where relevant) of holder of premises licence:

Thursdays (UK) Limited
Grant House
101 Bourges Boulevard
Peterborough
PE1 1NG

Registered number of holder, for example company number, charity number (where applicable)

06034603

Name, address and telephone number of designated premises supervisor where the premises licence authorises the supply of alcohol:

Name: Sergio Miguel Lopes Soares

Please note: It is the policy of the Licensing Authority not to display the address details of a designated premises supervisor.

Personal licence number and issuing authority of personal licence held by designated premises supervisor where the premises licence authorises for the supply of alcohol:

Licence Number: PHL2021024
Licensing Authority: Thurrock Council

Date: 13 January 2021

This licence has been authorised by Michelle Steward on behalf of the Director - Public Protection and Licensing.

Annex 1 – Mandatory conditions

1. No supply of alcohol may be made at a time when there is no designated premises supervisor in respect of this licence.
2. No supply of alcohol may be made at a time when the designated premises supervisor does not hold a personal licence or the personal licence is suspended.
3. Every supply of alcohol under this licence must be made or authorised by a person who holds a personal licence.
4.
 - (1) The responsible person must ensure that staff on relevant premises do not carry out, arrange or participate in any irresponsible promotions in relation to the premises.
 - (2) In this paragraph, an irresponsible promotion means any one or more of the following activities, or substantially similar activities, carried on for the purpose of encouraging the sale or supply of alcohol for consumption on the premises—
 - (a) games or other activities which require or encourage, or are designed to require or encourage, individuals to;
 - (i) drink a quantity of alcohol within a time limit (other than to drink alcohol sold or supplied on the premises before the cessation of the period in which the responsible person is authorised to sell or supply alcohol), or
 - (ii) drink as much alcohol as possible (whether within a time limit or otherwise);
 - (b) provision of unlimited or unspecified quantities of alcohol free or for a fixed or discounted fee to the public or to a group defined by a particular characteristic in a manner which carries a significant risk of undermining a licensing objective;
 - (c) provision of free or discounted alcohol or any other thing as a prize to encourage or reward the purchase and consumption of alcohol over a period of 24 hours or less in a manner which carries a significant risk of undermining a licensing objective;
 - (d) selling or supplying alcohol in association with promotional posters or flyers on, or in the vicinity of, the premises which can reasonably be considered to condone, encourage or glamorise anti-social behaviour or to refer to the effects of drunkenness in any favourable manner;
 - (e) dispensing alcohol directly by one person into the mouth of another (other than where that other person is unable to drink without assistance by reason of a disability).
5. The responsible person must ensure that free potable water is provided on request to customers where it is reasonably available.
6.
 - (1) The premises licence holder or club premises certificate holder must ensure that an age verification policy is adopted in respect of the premises in relation to the sale or supply of alcohol.
 - (2) The designated premises supervisor in relation to the premises licence must ensure that the supply of alcohol at the premises is carried on in accordance with the age verification policy.

- (3) The policy must require individuals who appear to the responsible person to be under 18 years of age (or such older age as may be specified in the policy) to produce on request, before being served alcohol, identification bearing their photograph, date of birth and either—
 - (a) a holographic mark, or
 - (b) an ultraviolet feature.

7. The responsible person must ensure that—

- (a) where any of the following alcoholic drinks is sold or supplied for consumption on the premises (other than alcoholic drinks sold or supplied having been made up in advance ready for sale or supply in a securely closed container) it is available to customers in the following measures—
 - (i) beer or cider: ½ pint;
 - (ii) gin, rum, vodka or whisky: 25 ml or 35 ml; and
 - (iii) still wine in a glass: 125 ml;
- (b) these measures are displayed in a menu, price list or other printed material which is available to customers on the premises; and
- (c) where a customer does not in relation to a sale of alcohol specify the quantity of alcohol to be sold, the customer is made aware that these measures are available.

A responsible person in relation to a licensed premises means the holder of the premise licence in respect of the premises, the designated premises supervisor (if any) or any individual aged 18 or over who is authorised by either the licence holder or designated premises supervisor. For premises with a club premises certificate, any member or officer of the club present on the premises in a capacity that which enables him to prevent the supply of alcohol.

8(i) A relevant person shall ensure that no alcohol is sold or supplied for consumption on or off the premises for a price which is less than the permitted price.

8(ii) For the purposes of the condition set out in paragraph 8(i) above -

- (a) "duty" is to be construed in accordance with the Alcoholic Liquor Duties Act 1979;
- (b) "permitted price" is the price found by applying the formula -

$$P = D+(D \times V)$$

Where -

- (i) P is the permitted price,
 - (ii) D is the amount of duty chargeable in relation to the alcohol as if the duty were charged on the date of the sale or supply of the alcohol, and
 - (iii) V is the rate of value added tax chargeable in relation to the alcohol as if the value added tax were charged on the date of the sale or supply of the alcohol;
- (c) "relevant person" means, in relation to premises in respect of which there is in force a premises licence -

- (i) the holder of the premises licence,
 - (ii) the designated premises supervisor (if any) in respect of such a licence, or
 - (iii) the personal licence holder who makes or authorises a supply of alcohol under such a licence;
- (d) "relevant person" means, in relation to premises in respect of which there is in force a club premises certificate, any member or officer of the club present on the premises in a capacity which enables the member or officer to prevent the supply in question; and
- (e) "value added tax" means value added tax charged in accordance with the Value Added Tax Act 1994.
- 8(iii). Where the permitted price given by Paragraph 8(ii)(b) above would (apart from this paragraph) not be a whole number of pennies, the price given by that sub-paragraph shall be taken to be the price actually given by that sub-paragraph rounded up to the nearest penny.
- 8(iv). (1) Sub-paragraph 8(iv)(2) below applies where the permitted price given by Paragraph 8(ii)(b) above on a day ("the first day") would be different from the permitted price on the next day ("the second day") as a result of a change to the rate of duty or value added tax.
- (2) The permitted price which would apply on the first day applies to sales or supplies of alcohol which take place before the expiry of the period of 14 days beginning on the second day.

Conditions reproducing the effect of conditions subject to which the relevant existing licences have effect

Conditions for Sale of Alcohol

9. Substantial food and suitable beverages other than intoxicating liquor (including drinking water) shall be available during the whole of the permitted hours in all parts of the premises where intoxicating liquor is sold or supplied.

Conditions which reproduce the effect of any restriction imposed on the use of the premises by specified enactment

10. (i) Alcohol shall not be sold, supplied, consumed in or taken from the premises except during permitted hours.

In this condition, permitted hours means:

- (a) On weekdays, other than Christmas Day, Good Friday or New Year's Eve, 10:00 to 23:00;
- (b) On Sundays, other than Christmas Day or New Year's Eve, 12:00 to 22:30;
- (c) On Good Friday, 12:00 to 22:30;
- (d) On Christmas Day, 12:00 to 15:00 and 19:00 to 22:30;
- (e) On New Year's Eve, except on a Sunday, 10:00 to 23:00;
- (f) On New Year's Eve on a Sunday, 12:00 to 22:30;
- (g) On New Year's Eve from the end of permitted hours on New Year's Eve to the start of permitted hours on the following day (or, if there are no permitted hours on the following day, midnight on 31st December).

- (ii) Alcohol may be sold or supplied for one hour following the hours set out above (other than Christmas Day and New Year's Eve), and on Christmas Day, between 15:00 and 19:00, to persons taking table meals in the premises in a part of the premises usually set apart for the service of such persons and for consumption by such a person in that part of the premises as an ancillary to his meal. For other purposes or in other parts of the premises the hours set out above shall continue to apply.
- (iii) (a) On Fridays and Saturdays only alcohol may be sold or supplied until 01:00 in the morning to persons taking table meals in the premises in a part of the premises usually set apart for the service of such persons and for consumption by that person in that part of the premises as an ancillary to his meal.
- (b) The alcohol must be sold or supplied at a time before (i) the provision of entertainment by persons present and performing or (ii) the provision of substantial refreshment has ended. For other purposes or in other parts of the premises the hours set out above shall continue to apply.
- (c) This condition does not authorise any sale or supply to any person admitted to the premises either after midnight or less than half an hour before the entertainment is due to end, except in accordance with condition number 10 (ii) above.

NOTE - The above restrictions do not prohibit:

- (a) during the first thirty minutes after the above hours the consumption of the alcohol on the premises;
- (b) during the first twenty minutes after the above hours, the taking of the alcohol from the premises unless the alcohol is supplied or taken in an open vessel;
- (c) during the first thirty minutes after the above hours the consumption of the alcohol on the premises by persons taking table meals there if the alcohol was supplied for consumption as ancillary to the meals;
- (d) the sale or supply of alcohol to or the consumption of alcohol by any person residing in the licensed premises;
- (e) the ordering of alcohol to be consumed off the premises, or the despatch by the vendor of the alcohol so ordered;
- (f) the sale of alcohol to a trader or registered club for the purposes of the trade or club;
- (g) the sale or supply of alcohol to any canteen or mess, being a canteen in which the sale or supply of alcohol is carried out under the authority of the Secretary of State or an authorised mess of members of Her Majesty's naval, military or air forces;
- (h) the taking of alcohol from the premises by a person residing there;
- (i) the supply of alcohol for consumption on the premises to any private friends of a person residing there who are bona fide entertained by him at his own expense, or the consumption of alcohol by persons so supplied;
- (j) the supply of alcohol for consumption on the premises to persons employed there for the purposes of the business carried on by the holder of the licence, or the consumption of liquor so supplied, if the liquor is supplied at the expense of their employer or of the person carrying on or in charge of the business on the premises.

In this condition, any reference to a person residing in the premises shall be construed as including a person not residing there but carrying on or in charge of the business on the premises.

11. The terminal hour for Late Night Refreshment on New Year's Eve is extended to 05:00 on New Year's Day.

Annex 2 – Conditions consistent with the operating Schedule

None

Annex 3 – Conditions attached after a hearing by the licensing authority

None

Annex 4 – Plans

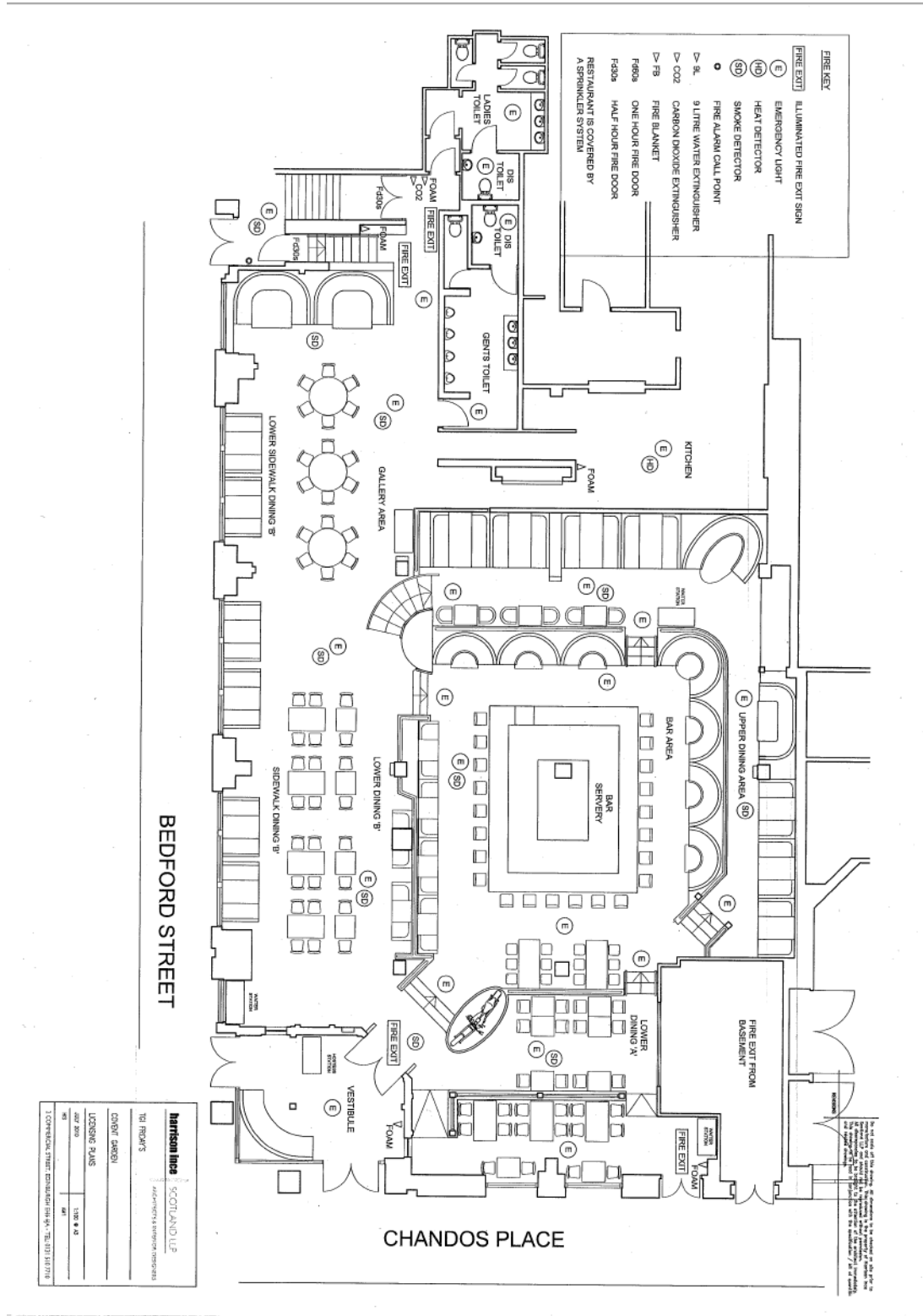



City of Westminster
64 Victoria Street, London,
SW1E 6QP

Schedule 12
Part B

WARD: St James's
UPRN: 010033529951

Premises licence
summary

Regulation 33, 34

Premises licence
number:

21/00270/LIPCH

Part 1 – Premises details

Postal address of premises:

TGI Fridays
Ground Floor
6 Bedford Street
London
WC2E 9HZ

Telephone Number: 020 7379 0585

Where the licence is time limited, the dates:

Not applicable

Licensable activities authorised by the licence:

Playing of Recorded Music
Late Night Refreshment
Private Entertainment consisting of dancing, music or other entertainment of a like kind for consideration and with a view to profit
Sale by Retail of Alcohol

The times the licence authorises the carrying out of licensable activities:

Playing of Recorded Music Unrestricted

Late Night Refreshment

Monday to Thursday:	23:00 to 00:30
Friday to Saturday:	23:00 to 01:30
Sunday:	23:00 to 00:00

Private Entertainment consisting of dancing, music or other entertainment of a like kind for consideration and with a view to profit Unrestricted

Sale by Retail of Alcohol

Monday to Thursday:	10:00 to 00:00
Friday to Saturday:	10:00 to 01:00
Sunday:	12:00 to 23:30

For times authorised for Christmas, New Year and Good Friday see conditions at Annex 1

The opening hours of the premises:

Monday to Thursday:	10:00 to 00:30
Friday to Saturday:	10:00 to 01:30
Sunday:	12:00 to 00:00

Where the licence authorises supplies of alcohol, whether these are on and/or off supplies:

Alcohol is supplied for consumption both on and off the Premises.

Name and (registered) address of holder of premises licence:

Thursdays (UK) Limited
Grant House
101 Bourges Boulevard
Peterborough
PE1 1NG

Registered number of holder, for example company number, charity number (where applicable)

06034603

Name of designated premises supervisor where the premises licence authorises for the supply of alcohol:

Name: Sergio Miguel Lopes Soares

State whether access to the premises by children is restricted or prohibited:

Restricted

Date: 13 January 2021

This licence has been authorised by Michelle Steward on behalf of the Director - Public Protection and Licensing.

Licence & Appeal History

Application	Details of Application	Date Determined	Decision
05/06114/LIPC	<p>Conversion Licence</p> <p>Recorded Music: Monday to Thursday 10:00 to 00:00 Friday to Saturday 10:00 to 01:00 Sunday 12:00 to 23:30</p> <p>Sale by Retail of Alcohol: Monday to Thursday 10:00 to 00:00 Friday to Saturday 10:00 to 01:00 Sunday 12:00 to 23:30</p> <p>Late Night Refreshment: Monday to Thursday 23:00 to 00:30 Friday to Saturday 23:00 to 01:30 Sunday 23:00 to 00:00</p>	28.08.2005	Granted under Delegated Authority
07/02210/LIPT	Transfer application - T.G.I. Friday's UK Limited	21.03.2007	Granted under Delegated Authority
06/08071/WCCMAP	<p>Master Licence</p> <p>Recorded Music: Unrestricted</p> <p>Private Entertainment consisting of dancing, music or other entertainment of a like kind for consideration and with a view to profit Unrestricted</p> <p>Sale by Retail of Alcohol: Monday to Thursday 10:00 to 00:00 Friday to Saturday 10:00 to 01:00 Sunday 12:00 to 23:30</p>	04.04.2007	Granted under Delegated Authority

	<p>Late Night Refreshment: Monday to Thursday 23:00 to 00:30 Friday to Saturday 23:00 to 01:30 Sunday 23:00 to 00:00</p>		
07/09830/LIPV	<p>Variation application: To extend the terminal hour for late night refreshment and sale of alcohol until 01:00 Monday to Saturday and until 00:00 on Sundays within the restaurant area of the premises.</p>	24.01.2008	Refused by Licensing Sub-Committee
08/04821/LIPDPS	<p>Application to vary the Designated premises supervisor</p>	06.06.2008	Granted under Delegated Authority
08/06684/LIPDPS	<p>Application to vary the Designated premises supervisor</p>	06.08.2008	Granted under Delegated Authority
09/06914/LIPV	<p>Variation application: To remove the restriction on persons under 14 in relation to their presence at the premises.</p>	15.10.2009	Granted under Delegated Authority
09/07473/LIPV	<p>Variation application: To remove the restriction on persons under 14 in relation to their presence at the premises.</p>	05.11.2009	Granted under Delegated Authority
10/04082/LIPRW	<p>Removal of a works condition</p>	06.07.2010	Granted under Delegated Authority
10/04282/LIPVM	<p>Minor Variation: To provide revised plans following internal alterations</p>	27.07.2010	Granted under Delegated Authority
10/10587/LIPCH	<p>Change of details</p>	24.12.2010	Granted under Delegated Authority

11/04221/LIPDPS	Application to vary the Designated premises supervisor	10.06.2011	Granted under Delegated Authority
13/06386/LIPDPS	Application to vary the Designated premises supervisor	13.09.2013	Granted under Delegated Authority
14/01049/LIPDPS	Application to vary the Designated premises supervisor	04.03.2014	Granted under Delegated Authority
15/00260/LIPDPS	Application to vary the Designated premises supervisor	11.02.2015	Granted under Delegated Authority
15/01096/LIPDPS	Application to vary the Designated premises supervisor	29.07.2015	Granted under Delegated Authority
16/10358/LIPDPS	Application to vary the Designated premises supervisor	26.01.2017	Granted under Delegated Authority
18/05832/LIPDPS	Application to vary the Designated premises supervisor	28.09.2018	Granted under Delegated Authority
20/03033/LIPDPS	Application to vary the Designated premises supervisor	09.04.2020	Granted under Delegated Authority
20/11148/LIPDPS	Application to vary the Designated premises supervisor	13.01.2021	Granted under Delegated Authority
21/00270/LIPCH	Change of details	13.01.2021	Granted under Delegated Authority

There is no Temporary Event Notice or appeal history.

CONDITIONS CONSISTENT WITH THE OPERATING SCHEDULE AND CONDITIONS PROPOSED BY A PARTY TO THE HEARING

When determining an application for a new premises licence under the provisions of the Licensing Act 2003, the licensing authority must, unless it decides to reject the application, grant the licence subject to the conditions which are indicated as mandatory in this schedule.

At a hearing the licensing authority may, in addition, and having regard to any representations received, grant the licence subject to such conditions which are consistent with the operating schedule submitted by the applicant as part of their application, or alter or omit these conditions, or add any new condition to such extent as the licensing authority considers necessary for the promotion of the licensing objectives.

This schedule lists those conditions which are consistent with the operating schedule, or proposed as necessary for the promotion of the licensing objectives by a responsible authority or an interested party as indicated. These conditions have not been submitted by the licensing service but reflect the positions of the applicant, responsible authority or interested party and have not necessarily been agreed

Mandatory Conditions

1. No supply of alcohol may be made at a time when there is no designated premises supervisor in respect of this licence.
2. No supply of alcohol may be made at a time when the designated premises supervisor does not hold a personal licence or the personal licence is suspended.
3. Every supply of alcohol under this licence must be made or authorised by a person who holds a personal licence.
4.
 - (1) The responsible person must ensure that staff on relevant premises do not carry out, arrange or participate in any irresponsible promotions in relation to the premises.
 - (2) In this paragraph, an irresponsible promotion means any one or more of the following activities, or substantially similar activities, carried on for the purpose of encouraging the sale or supply of alcohol for consumption on the premises—
 - (a) games or other activities which require or encourage, or are designed to require or encourage, individuals to;
 - (i) drink a quantity of alcohol within a time limit (other than to drink alcohol sold or supplied on the premises before the cessation of the period in which the responsible person is authorised to sell or supply alcohol), or
 - (ii) drink as much alcohol as possible (whether within a time limit or otherwise);
 - (b) provision of unlimited or unspecified quantities of alcohol free or for a fixed or discounted fee to the public or to a group defined by a particular characteristic in a manner which carries a significant risk of undermining a licensing objective;
 - (c) provision of free or discounted alcohol or any other thing as a prize to encourage or reward the purchase and consumption of alcohol over a period of 24 hours or

less in a manner which carries a significant risk of undermining a licensing objective;

- (d) selling or supplying alcohol in association with promotional posters or flyers on, or in the vicinity of, the premises which can reasonably be considered to condone, encourage or glamorise anti-social behaviour or to refer to the effects of drunkenness in any favourable manner;
 - (e) dispensing alcohol directly by one person into the mouth of another (other than where that other person is unable to drink without assistance by reason of a disability).
5. The responsible person must ensure that free potable water is provided on request to customers where it is reasonably available.
6. (1) The premises licence holder or club premises certificate holder must ensure that an age verification policy is adopted in respect of the premises in relation to the sale or supply of alcohol.
- (2) The designated premises supervisor in relation to the premises licence must ensure that the supply of alcohol at the premises is carried on in accordance with the age verification policy.
- (3) The policy must require individuals who appear to the responsible person to be under 18 years of age (or such older age as may be specified in the policy) to produce on request, before being served alcohol, identification bearing their photograph, date of birth and either—
- (a) a holographic mark, or
 - (b) an ultraviolet feature.
7. The responsible person must ensure that—
- (a) where any of the following alcoholic drinks is sold or supplied for consumption on the premises (other than alcoholic drinks sold or supplied having been made up in advance ready for sale or supply in a securely closed container) it is available to customers in the following measures—
 - (i) beer or cider: ½ pint;
 - (ii) gin, rum, vodka or whisky: 25 ml or 35 ml; and
 - (iii) still wine in a glass: 125 ml;
 - (b) these measures are displayed in a menu, price list or other printed material which is available to customers on the premises; and
 - (c) where a customer does not in relation to a sale of alcohol specify the quantity of alcohol to be sold, the customer is made aware that these measures are available.

A responsible person in relation to a licensed premises means the holder of the premise licence in respect of the premises, the designated premises supervisor (if any) or any individual aged 18 or over who is authorised by either the licence holder or designated premises supervisor. For premises with a club premises certificate, any member or officer of the club present on the premises in a capacity that which enables him to prevent the supply of alcohol.

8(i) A relevant person shall ensure that no alcohol is sold or supplied for consumption on or off the premises for a price which is less than the permitted price.

8(ii) For the purposes of the condition set out in paragraph 8(i) above -

(a) "duty" is to be construed in accordance with the Alcoholic Liquor Duties Act 1979;

(b) "permitted price" is the price found by applying the formula -

$$P = D + (D \times V)$$

Where -

(i) P is the permitted price,

(ii) D is the amount of duty chargeable in relation to the alcohol as if the duty were charged on the date of the sale or supply of the alcohol, and

(iii) V is the rate of value added tax chargeable in relation to the alcohol as if the value added tax were charged on the date of the sale or supply of the alcohol;

(c) "relevant person" means, in relation to premises in respect of which there is in force a premises licence -

(i) the holder of the premises licence,

(ii) the designated premises supervisor (if any) in respect of such a licence, or

(iii) the personal licence holder who makes or authorises a supply of alcohol under such a licence;

(d) "relevant person" means, in relation to premises in respect of which there is in force a club premises certificate, any member or officer of the club present on the premises in a capacity which enables the member or officer to prevent the supply in question; and

(e) "value added tax" means value added tax charged in accordance with the Value Added Tax Act 1994.

8(iii). Where the permitted price given by Paragraph 8(ii)(b) above would (apart from this paragraph) not be a whole number of pennies, the price given by that sub-paragraph shall be taken to be the price actually given by that sub-paragraph rounded up to the nearest penny.

8(iv). (1) Sub-paragraph 8(iv)(2) below applies where the permitted price given by Paragraph 8(ii)(b) above on a day ("the first day") would be different from the permitted price on the next day ("the second day") as a result of a change to the rate of duty or value added tax.

(2) The permitted price which would apply on the first day applies to sales or supplies of alcohol which take place before the expiry of the period of 14 days beginning on the second day.

Conditions reproducing the effect of conditions subject to which the relevant existing licences have effect

Conditions for Sale of Alcohol

9. Substantial food and suitable beverages other than intoxicating liquor (including drinking water) shall be available during the whole of the permitted hours in all parts of the premises where intoxicating liquor is sold or supplied.

Conditions which reproduce the effect of any restriction imposed on the use of the premises by specified enactment

10. (i) Alcohol shall not be sold, supplied, consumed in or taken from the premises except during permitted hours.

In this condition, permitted hours means:

- (a) On weekdays, other than Christmas Day, Good Friday or New Year's Eve, 10:00 to 23:00;
 - (b) On Sundays, other than Christmas Day or New Year's Eve, 12:00 to 22:30;
 - (c) On Good Friday, 12:00 to 22:30;
 - (d) On Christmas Day, 12:00 to 15:00 and 19:00 to 22:30;
 - (e) On New Year's Eve, except on a Sunday, 10:00 to 23:00;
 - (f) On New Year's Eve on a Sunday, 12:00 to 22:30;
 - (g) On New Year's Eve from the end of permitted hours on New Year's Eve to the start of permitted hours on the following day (or, if there are no permitted hours on the following day, midnight on 31st December).
- (ii) Alcohol may be sold or supplied for one hour following the hours set out above (other than Christmas Day and New Year's Eve), and on Christmas Day, between 15:00 and 19:00, to persons taking table meals in the premises in a part of the premises usually set apart for the service of such persons and for consumption by such a person in that part of the premises as an ancillary to his meal. For other purposes or in other parts of the premises the hours set out above shall continue to apply.
- (iii) (a) On Fridays and Saturdays only alcohol may be sold or supplied until 01:00 in the morning to persons taking table meals in the premises in a part of the premises usually set apart for the service of such persons and for consumption by that person in that part of the premises as an ancillary to his meal.
- (b) The alcohol must be sold or supplied at a time before (i) the provision of entertainment by persons present and performing or (ii) the provision of substantial refreshment has ended. For other purposes or in other parts of the premises the hours set out above shall continue to apply.
- (c) This condition does not authorise any sale or supply to any person admitted to the premises either after midnight or less than half an hour before the entertainment is due to end, except in accordance with condition number 10 (ii) above.

NOTE - The above restrictions do not prohibit:

- (a) during the first thirty minutes after the above hours the consumption of the alcohol on the premises;
- (b) during the first twenty minutes after the above hours, the taking of the alcohol from the premises unless the alcohol is supplied or taken in an open vessel;

- (c) during the first thirty minutes after the above hours the consumption of the alcohol on the premises by persons taking table meals there if the alcohol was supplied for consumption as ancillary to the meals;
- (d) the sale or supply of alcohol to or the consumption of alcohol by any person residing in the licensed premises;
- (e) the ordering of alcohol to be consumed off the premises, or the despatch by the vendor of the alcohol so ordered;
- (f) the sale of alcohol to a trader or registered club for the purposes of the trade or club;
- (g) the sale or supply of alcohol to any canteen or mess, being a canteen in which the sale or supply of alcohol is carried out under the authority of the Secretary of State or an authorised mess of members of Her Majesty's naval, military or air forces;
- (h) the taking of alcohol from the premises by a person residing there;
- (i) the supply of alcohol for consumption on the premises to any private friends of a person residing there who are bona fide entertained by him at his own expense, or the consumption of alcohol by persons so supplied;
- (j) the supply of alcohol for consumption on the premises to persons employed there for the purposes of the business carried on by the holder of the licence, or the consumption of liquor so supplied, if the liquor is supplied at the expense of their employer or of the person carrying on or in charge of the business on the premises.

In this condition, any reference to a person residing in the premises shall be construed as including a person not residing there but carrying on or in charge of the business on the premises.

11. The terminal hour for Late Night Refreshment on New Year's Eve is extended to 05:00 on New Year's Day.

Annex 2 – Conditions consistent with the operating Schedule

None

Annex 3 – Conditions attached after a hearing by the licensing authority

None

Conditions proposed by the Licensing Authority and agreed with the applicant so as to form part of the operating schedule.

12. The shadow licence will not take effect when the current licence is in operation.

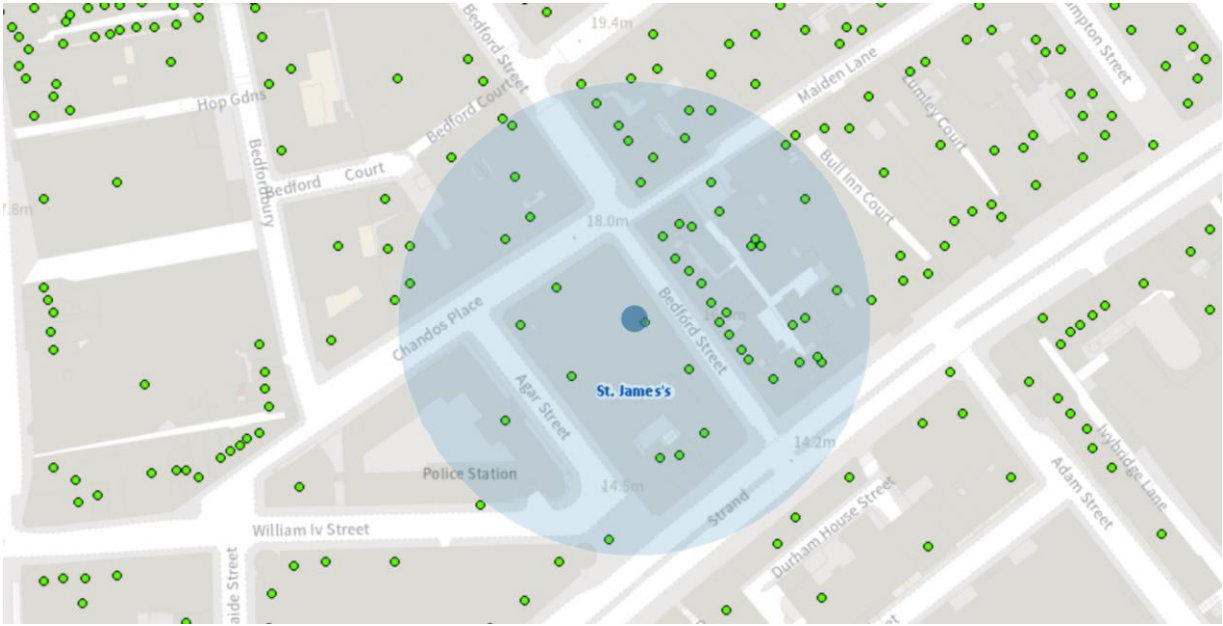

Resident count: 60

Licensed premises within 75 metres of Ground Floor, 6 Bedford Street, London, WC2E 9HZ

Licence Number	Trading Name	Address	Premises Type	Time Period
21/00270/LIPCH	TGI Fridays	Ground Floor 6 Bedford Street London WC2E 9HZ	Restaurant	Sunday; 12:00 - 00:00 Monday to Thursday; 10:00 - 00:30 Friday to Saturday; 10:00 - 01:30
20/03033/LIPDPS	TGI Fridays	Ground Floor 6 Bedford Street London WC2E 9HZ	Restaurant	Sunday; 12:00 - 00:00 Monday to Thursday; 10:00 - 00:30 Friday to Saturday; 10:00 - 01:30
17/08375/LIPT	Strand Tandoori	45 Bedford Street London WC2E 9HA	Not Recorded	Sunday; 12:00 - 00:00 Monday to Sunday; 10:00 - 00:30
18/14542/LIPDPS	Carbon (Bedford Street)	46 Bedford Street London WC2E 9HA	Restaurant	Sunday; 11:00 - 23:00 Monday to Thursday; 11:00 - 23:00 Friday to Saturday; 11:00 - 00:00
19/00356/LIPN	Kalamaki Street Greek	Basement And Ground Floor 49 Bedford Street London WC2E 9HA	Restaurant	Monday to Sunday; 11:00 - 23:00
17/14664/LIPDPS	Ping Pong	23 - 24 Maiden Lane London WC2E 7NP	Restaurant	Sunday; 12:00 - 00:00 Monday to Saturday; 10:00 - 00:30
19/14676/LIPV	Not Recorded	50 Bedford Street London WC2E 9HA	Hotel, 3 star or under	Monday; 00:00 - 00:00 Tuesday; 00:00 - 00:00 Wednesday; 00:00 - 00:00 Thursday; 00:00 - 00:00 Friday; 00:00 - 00:00 Saturday; 00:00 - 00:00 Sunday; 00:00 - 00:00
17/09999/LIPV	Bakery Covent	Basement	Cafe	Not Recorded;

	Garden	And Ground Floor 6 - 7 Chandos Place London WC2N 4HU		XXXX - XXXX
15/03758/LIPN	The Whisky Exchange	2 Bedford Street London WC2E 9HD	Shop	Sunday; 10:00 - 22:30 Monday to Saturday; 08:00 - 23:00
20/00229/LIPDPS	Bedford And Strand	1A Bedford Street London WC2E 9HD	Wine bar	Sunday; 12:00 - 00:00 Monday to Saturday; 10:00 - 00:30
21/05025/LIPDPS	Mr Fogg's SOE	1A Bedford Street London WC2E 9HD	Wine bar	Monday; 08:00 - 02:30 Tuesday; 08:00 - 02:30 Wednesday; 08:00 - 02:30 Thursday; 08:00 - 02:30 Friday; 08:00 - 02:30 Saturday; 08:00 - 02:30 Sunday; 10:00 - 00:30
14/06782/LIPVM	The Porterhouse Public House	21-22 Maiden Lane London WC2E 7NA	Restaurant	Sunday; 12:00 - 23:00 Monday to Saturday; 09:00 - 00:30
18/01407/LIPVM	Nandos	67-68 Chandos Place London WC2N 4HG	Restaurant	Not Recorded; XXXX - XXXX
21/11698/LIPT	Wahaca	66 Chandos Place London SW1A 1AB	Restaurant	Sunday; 10:00 - 00:00 Monday to Saturday; 10:00 - 00:30
21/07321/LIPDPS	Not Recorded	419 - 420 Strand London WC2R 0PT	Restaurant	Sunday; 12:00 - 22:00 Monday to Saturday; 11:00 - 23:00
19/14898/LIPT	Garfunkels Restaurants	Basement To Ground Floor 419 - 420 Strand London WC2R 0PT	Restaurant	Sunday; 12:00 - 00:00 Monday to Saturday; 10:00 - 00:30
12/09819/LIPVM	The Port House	417 Strand London WC2R 0PD	Restaurant	Sunday; 12:00 - 00:00 Monday to Saturday; 10:00 - 00:30
20/11850/LIPN	Z Hotels Strand, Heathcock	Ground Floor Rear 1	Hotel, 4+ star or major chain	Sunday; 09:00 - 22:30 Monday

	Court, 415 Strand	Heathcock Court London WC2R 0NT		to Thursday; 09:00 - 23:03 Friday to Saturday; 09:00 - 00:00 Sundays before Bank Holidays; 09:00 - 00:00
20/11122/LIPDPS	Adelphi Theatre	411 Strand London WC2R 0NS	Theatre	Monday to Friday; 09:00 - 04:00 Saturday to Sunday; 09:00 - 00:00
21/02120/LIPDPS	Cinnamon (First Second Floors)	28 Maiden Lane London WC2E 7JS	Restaurant	Sunday; 10:00 - 23:00 Monday to Thursday; 10:00 - 00:00 Friday to Saturday; 10:00 - 00:30 Sundays before Bank Holidays; 12:00 - 00:00
21/02130/LIPDPS	Cinnamon (Basement Ground Floor)	28 Maiden Lane London WC2E 7JS	Restaurant	Sunday; 12:00 - 00:00 Monday to Saturday; 10:00 - 00:30
20/01316/LIPDPS	All Bar One	Basement And Ground Floor 35-36 Bedford Street London WC2E 9EN	Public house or pub restaurant	Sunday; 08:00 - 22:50 Monday to Thursday; 08:00 - 23:30 Friday to Saturday; 08:00 - 00:00 Sundays before Bank Holidays; 08:00 - 00:00
21/07735/LIPVM	Ave Mario - 15 Henrietta Street &	29-30 Maiden Lane London WC2E 7JS	Restaurant	Monday; 08:00 - 01:00 Tuesday; 08:00 - 01:00 Wednesday; 08:00 - 01:30 Thursday; 08:00 - 01:30 Friday; 08:00 - 01:30 Saturday; 08:00 - 01:30 Sunday; 08:00 - 01:00
13/02658/LIPN	School Of Wok	61 Chandos Place London WC2N 4HG	Educational	Monday to Saturday; 10:00 - 23:00
19/08907/LIPN	Unit 2	15 Bedford	Restaurant	Monday; 10:00

		Street London WC2E 9HE		- 23:30 Tuesday; 10:00 - 23:30 Wednesday; 10:00 - 23:30 Thursday; 10:00 - 23:30 Friday; 10:00 - 00:00 Saturday; 10:00 - 00:00 Sunday; 12:00 - 22:30
21/13942/LIPVM	Unit 2	15 Bedford Street London WC2E 9HE	Restaurant	Monday; 10:00 - 23:30 Tuesday; 10:00 - 23:30 Wednesday; 10:00 - 23:30 Thursday; 10:00 - 23:30 Friday; 10:00 - 00:00 Saturday; 10:00 - 00:00 Sunday; 12:00 - 22:30